

HOME AND LAND

Domaine homes



HOME SIZE: 205.5M²

LAND SIZE: 445M²

🛏 4 🚿 2 🚗 2 🚗 2

\$753,500*

NEVADA 22 SORRENTO FACADE

Lot 2409 Outrigger Drive, Teralba, Billy's Lookout Estate

HOUSE AND LAND PACKAGE INCLUSIONS

- Lifetime Structural Guarantee
- Allowance for additional site costs
- 900mm oven, cooktop and rangehood
- 20mm stone kitchen benchtops
- Laminated overhead cupboards with bulkheads
- Soft close drawers and doors to kitchen and bathrooms
- Stainless steel dishwasher
- Roller blinds and flyscreens to opening windows
- Floor coverings
- Fully Ducted Air Conditioning
- 3.3kW Solar Package
- And much, much more...

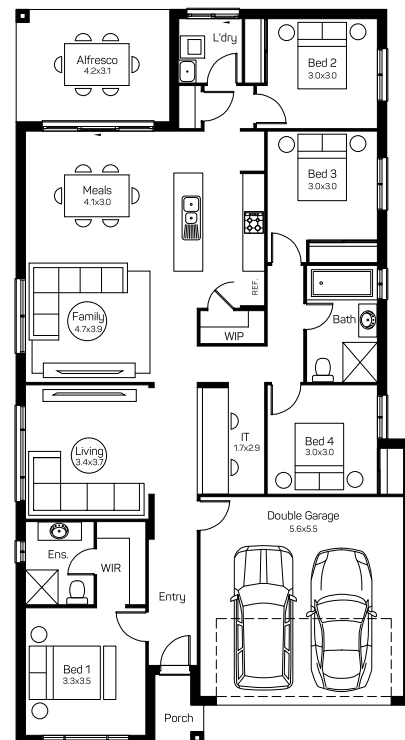

Domaine Homes | contact@domainehomes.com.au | 13 64 69

*Facade image may depict features not included in the package prices shown such as render, tiling, lighting, roof covering, timber decking and landscaping. Plans are subject to approval by the Principal Developer and Local Authorities. Domaine Homes NSW reserves the right to withdraw or alter this package at any time without notice. Allowance for site costs included. Pricing is subject to change without notice. Domaine Homes NSW is not the owner of the land and is not responsible for final site dimensions or registration times. All information given at this time is believed to be correct.