

LOT 1801, SIDELIGHT STREET, BILLY'S LOOKOUT

MASTER PLAN

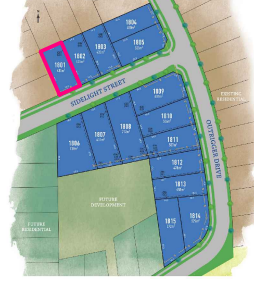

STAGE PLAN



PRELIMINARY SITE ANALYSIS PLAN

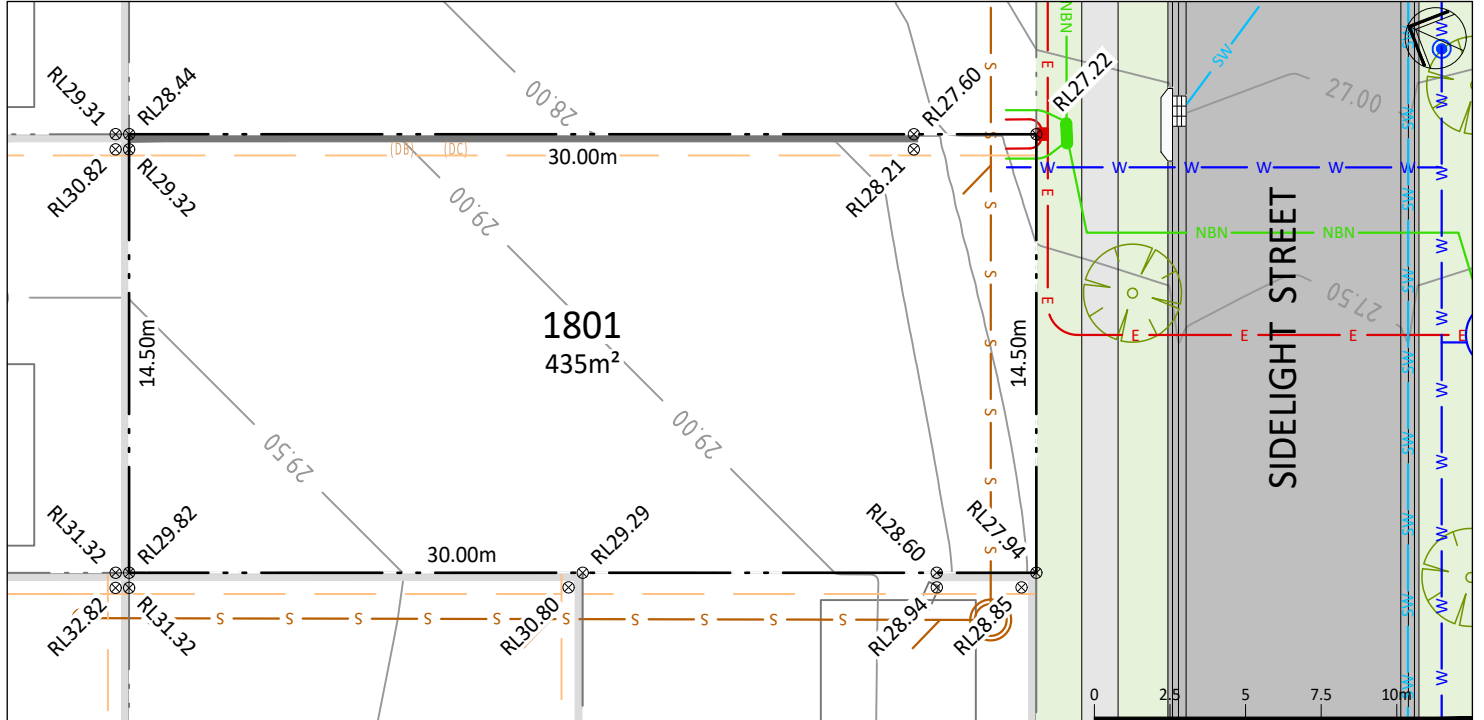

LEGEND:

	RETAINING WALL
	STORMWATER PIT
	STORMWATER PIPE
	DRAINAGE SWALE
	SEWER MAIN
	SEWER MAINTENANCE STRUCTURE
	SEWER JUNCTION
	WATERMAIN
	HYDRANT / STOP VALVE
	TELSTRA / NBN
	TELSTRA / NBN PIT
	UNDERGROUND POWER
	ELECTRICITY PILLAR
	LIGHT POLE
	EASEMENT
	STREET TREES
	CONTOURS
	BUILDING ENVELOPE

DISCLAIMER / NOTES:

1. Contours are based on finished design levels and are subject to construction and Council certification and therefore should not be considered as final or as-built.
2. Location of utility services including but not limited to power, water, sewer, communications and gas are subject to construction and supply authority certification and therefore should not be considered as final or as-built.
3. Survey information such as boundary dimensions and areas, easements etc are subject to final survey. Purchasers should refer to the deposited plan and 88B instrument contained in the contract for sale of land for further detailed information.
4. Bushfire and geotechnical classification are provided for convenience. Purchasers should refer to referenced detail specialist reports.
5. This preliminary site analysis plan has been collated from various sources of design information and is provided for convenience to assist purchasers in obtaining quotation / tenders for dwelling construction.
6. This document does not form part of the contract of sale of the land.
7. Anticipated site classification is M - H2 or better (to be confirmed at completion of construction).
8. Refer to sales plan and draft contract for information regarding easements and restrictions.
9. Refer to build envelope plans for further details.

(DA) - EASEMENT TO DRAIN WATER 2 WIDE

(DB) - RESTRICTION ON THE USE OF LAND 0.7 WIDE

(DC) - EASEMENT FOR CONSTRUCTION & MAINTENANCE 0.7 WIDE

REVISION: STAGE 18 MARKETING

DATE: 9 JANUARY 2024

BY: NORTHPROP CONSULTING ENGINEERS



BILLY'S LOOKOUT

EST. 2015

LAKE MACQUARIE

LOT 1802, SIDELIGHT STREET, BILLY'S LOOKOUT

MASTER PLAN



STAGE PLAN

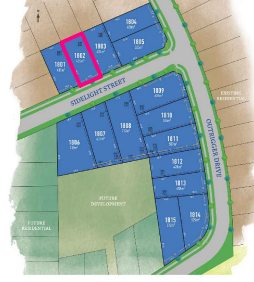

PRELIMINARY SITE ANALYSIS PLAN

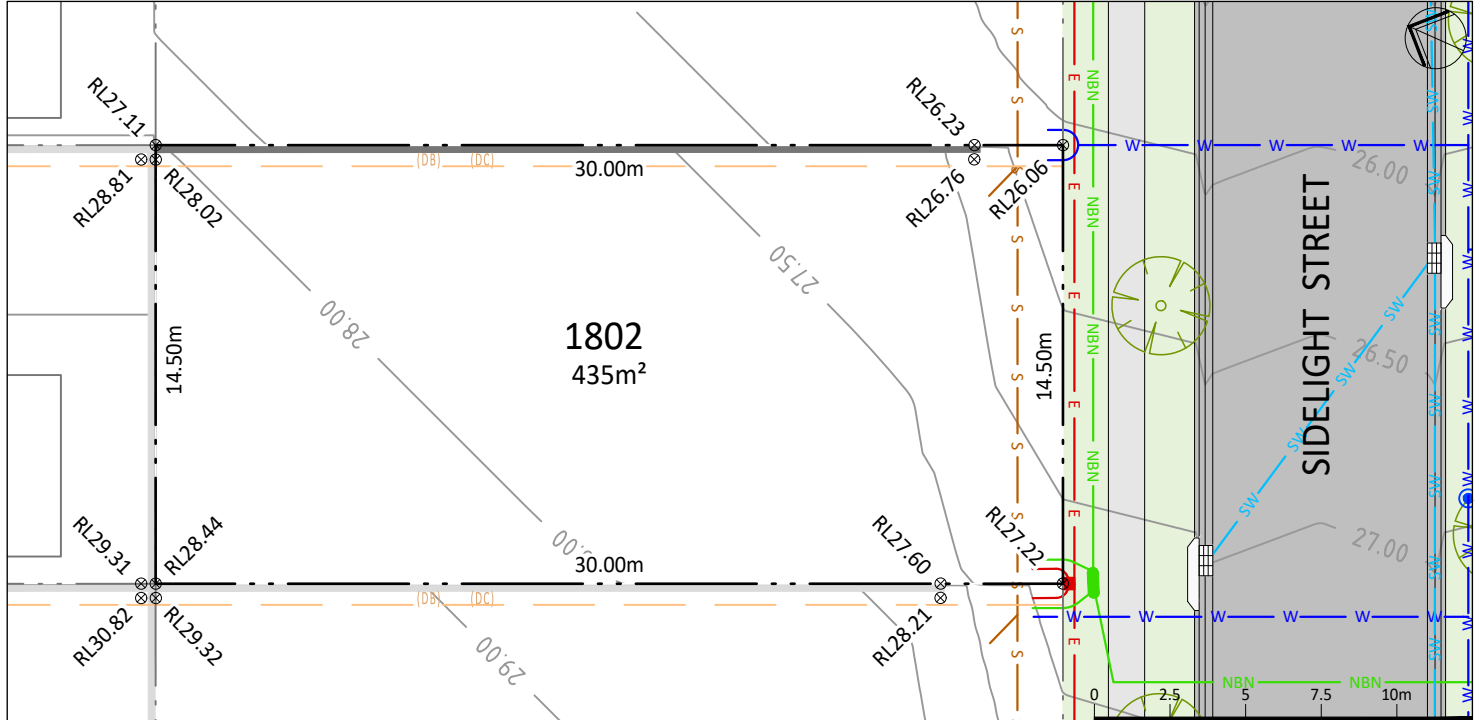

LEGEND:

	RETAINING WALL
	STORMWATER PIT
	STORMWATER PIPE
	DRAINAGE SWALE
	SEWER MAIN
	SEWER MAINTENANCE STRUCTURE
	SEWER JUNCTION
	WATERMAIN
	HYDRANT / STOP VALVE
	TELSTRA / NBN
	TELSTRA / NBN PIT
	UNDERGROUND POWER
	ELECTRICITY PILLAR
	LIGHT POLE
	EASEMENT
	STREET TREES
	CONTOURS
	BUILDING ENVELOPE

DISCLAIMER / NOTES:

- Contours are based on finished design levels and are subject to construction and Council certification and therefore should not be considered as final or as-built.
- Location of utility services including but not limited to power, water, sewer, communications and gas are subject to construction and supply authority certification and therefore should not be considered as final or as-built.
- Survey information such as boundary dimensions and areas, easements etc are subject to final survey. Purchasers should refer to the deposited plan and 88B instrument contained in the contract for sale of land for further detailed information.
- Bushfire and geotechnical classification are provided for convenience. Purchasers should refer to referenced detail specialist reports.
- This preliminary site analysis plan has been collated from various sources of design information and is provided for convenience to assist purchasers in obtaining quotation / tenders for dwelling construction.
- This document does not form part of the contract of sale of the land.
- Anticipated site classification is M - H2 or better (to be confirmed at completion of construction).
- Refer to sales plan and draft contract for information regarding easements and restrictions.
- Refer to build envelope plans for further details.

(DA) - EASEMENT TO DRAIN WATER 2 WIDE

(DB) - RESTRICTION ON THE USE OF LAND 0.7 WIDE

(DC) - EASEMENT FOR CONSTRUCTION & MAINTENANCE 0.7 WIDE

REVISION: STAGE 18 MARKETING

DATE: 9 JANUARY 2024

BY: NORTHPROP CONSULTING ENGINEERS

billyslookout.com.au



A QUALITY
MCCLOY
GROUP
PROJECT



BILLY'S LOOKOUT

EST. 2015

LAKE MACQUARIE

LOT 1803, SIDELIGHT STREET, BILLY'S LOOKOUT

MASTER PLAN



STAGE PLAN

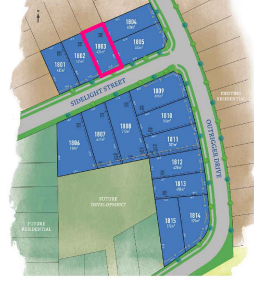

PRELIMINARY SITE ANALYSIS PLAN

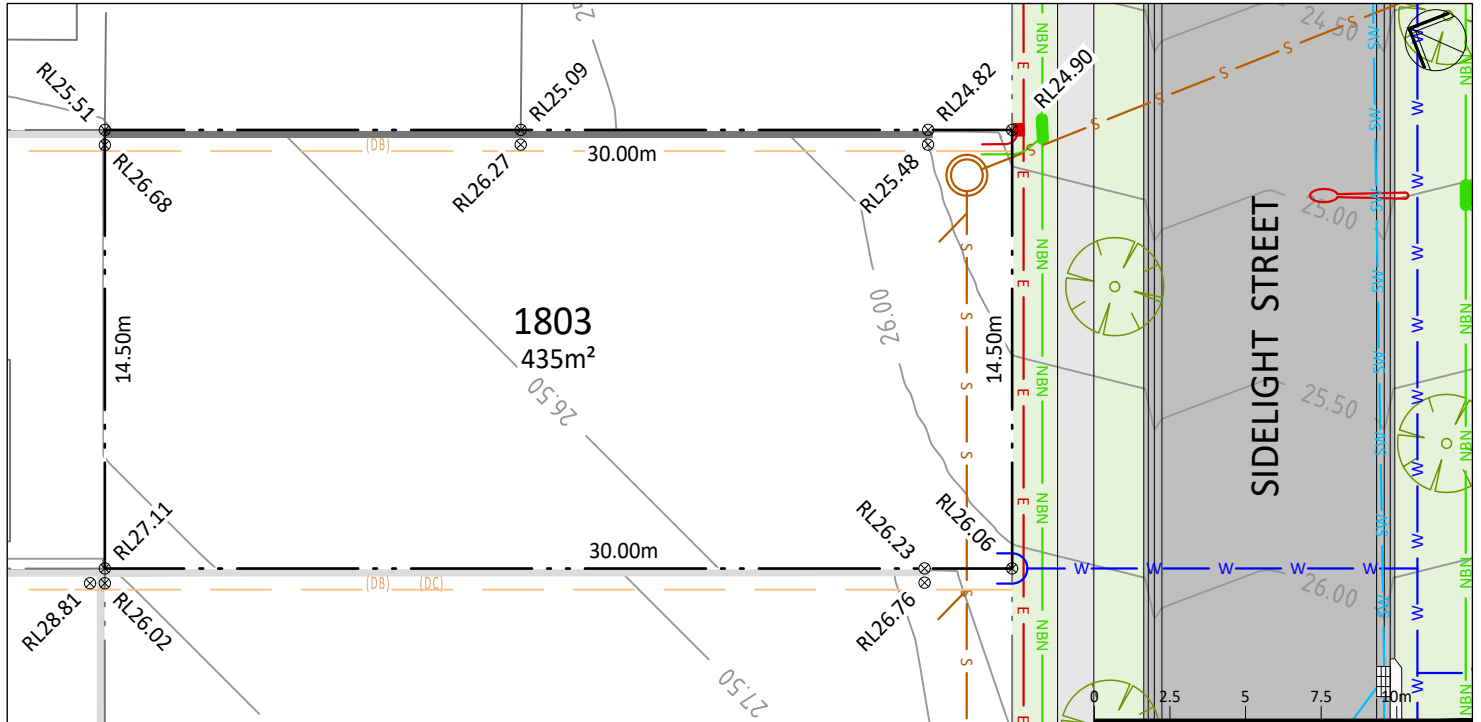

LEGEND:

	RETAINING WALL
	STORMWATER PIT
	STORMWATER PIPE
	DRAINAGE SWALE
	SEWER MAIN
	SEWER MAINTENANCE STRUCTURE
	SEWER JUNCTION
	WATERMAIN
	HYDRANT / STOP VALVE
	TELSTRA / NBN
	TELSTRA / NBN PIT
	UNDERGROUND POWER
	ELECTRICITY PILLAR
	LIGHT POLE
	EASEMENT
	STREET TREES
	CONTOURS
	BUILDING ENVELOPE

DISCLAIMER / NOTES:

- Contours are based on finished design levels and are subject to construction and Council certification and therefore should not be considered as final or as-built.
- Location of utility services including but not limited to power, water, sewer, communications and gas are subject to construction and supply authority certification and therefore should not be considered as final or as-built.
- Survey information such as boundary dimensions and areas, easements etc are subject to final survey. Purchasers should refer to the deposited plan and 88B instrument contained in the contract for sale of land for further detailed information.
- Bushfire and geotechnical classification are provided for convenience. Purchasers should refer to referenced detail specialist reports.
- This preliminary site analysis plan has been collated from various sources of design information and is provided for convenience to assist purchasers in obtaining quotation / tenders for dwelling construction.
- This document does not form part of the contract of sale of the land.
- Anticipated site classification is M - H2 or better (to be confirmed at completion of construction).
- Refer to sales plan and draft contract for information regarding easements and restrictions.
- Refer to build envelope plans for further details.

(DA) - EASEMENT TO DRAIN WATER 2 WIDE

(DB) - RESTRICTION ON THE USE OF LAND 0.7 WIDE

(DC) - EASEMENT FOR CONSTRUCTION & MAINTENANCE 0.7 WIDE

REVISION: STAGE 18 MARKETING

DATE: 9 JANUARY 2024

BY: NORTHPROP CONSULTING ENGINEERS

billyslookout.com.au



A QUALITY
MCCLOY
GROUP
PROJECT



**BILLY'S
LOOKOUT**

EST. 2015

LAKE MACQUARIE

LOT 1804, OUTRIGGER DRIVE, BILLY'S LOOKOUT

MASTER PLAN



STAGE PLAN

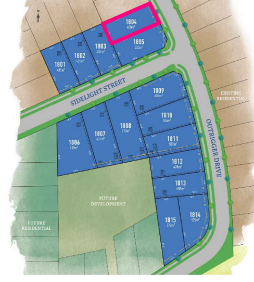

PRELIMINARY SITE ANALYSIS PLAN

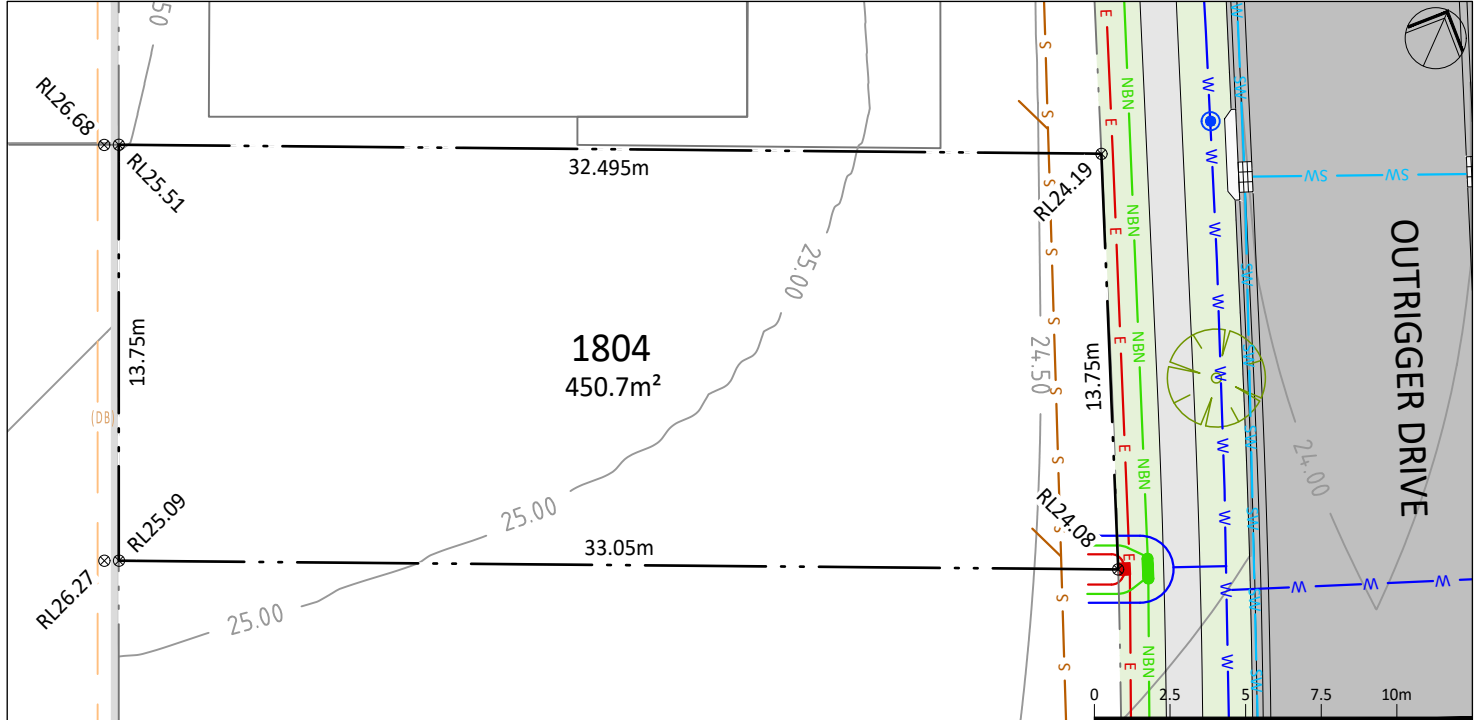

LEGEND:

	RETAINING WALL
	STORMWATER PIT
	STORMWATER PIPE
	DRAINAGE SWALE
	SEWER MAIN
	SEWER MAINTENANCE STRUCTURE
	SEWER JUNCTION
	WATERMAIN
	HYDRANT / STOP VALVE
	TELSTRA / NBN
	TELSTRA / NBN PIT
	UNDERGROUND POWER
	ELECTRICITY PILLAR
	LIGHT POLE
	EASEMENT
	STREET TREES
	CONTOURS
	BUILDING ENVELOPE

DISCLAIMER / NOTES:

- Contours are based on finished design levels and are subject to construction and Council certification and therefore should not be considered as final or as-built.
- Location of utility services including but not limited to power, water, sewer, communications and gas are subject to construction and supply authority certification and therefore should not be considered as final or as-built.
- Survey information such as boundary dimensions and areas, easements etc are subject to final survey. Purchasers should refer to the deposited plan and 88B instrument contained in the contract for sale of land for further detailed information.
- Bushfire and geotechnical classification are provided for convenience. Purchasers should refer to referenced detail specialist reports.
- This preliminary site analysis plan has been collated from various sources of design information and is provided for convenience to assist purchasers in obtaining quotation / tenders for dwelling construction.
- This document does not form part of the contract of sale of the land.
- Anticipated site classification is M - H2 or better (to be confirmed at completion of construction).
- Refer to sales plan and draft contract for information regarding easements and restrictions.
- Refer to build envelope plans for further details.

(DA) - EASEMENT TO DRAIN WATER 2 WIDE

(DB) - RESTRICTION ON THE USE OF LAND 0.7 WIDE

(DC) - EASEMENT FOR CONSTRUCTION & MAINTENANCE 0.7 WIDE

REVISION: STAGE 18 MARKETING

DATE: 9 JANUARY 2024

BY: NORTHPROP CONSULTING ENGINEERS

billyslookout.com.au



A QUALITY
MCCLOY
GROUP
PROJECT



**BILLY'S
LOOKOUT**

EST. 2015

LAKE MACQUARIE

LOT 1805, SIDELIGHT STREET, BILLY'S LOOKOUT

MASTER PLAN



STAGE PLAN

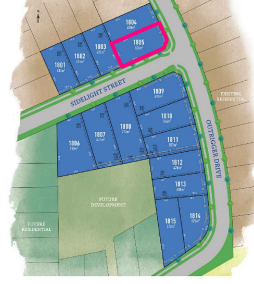

PRELIMINARY SITE ANALYSIS PLAN

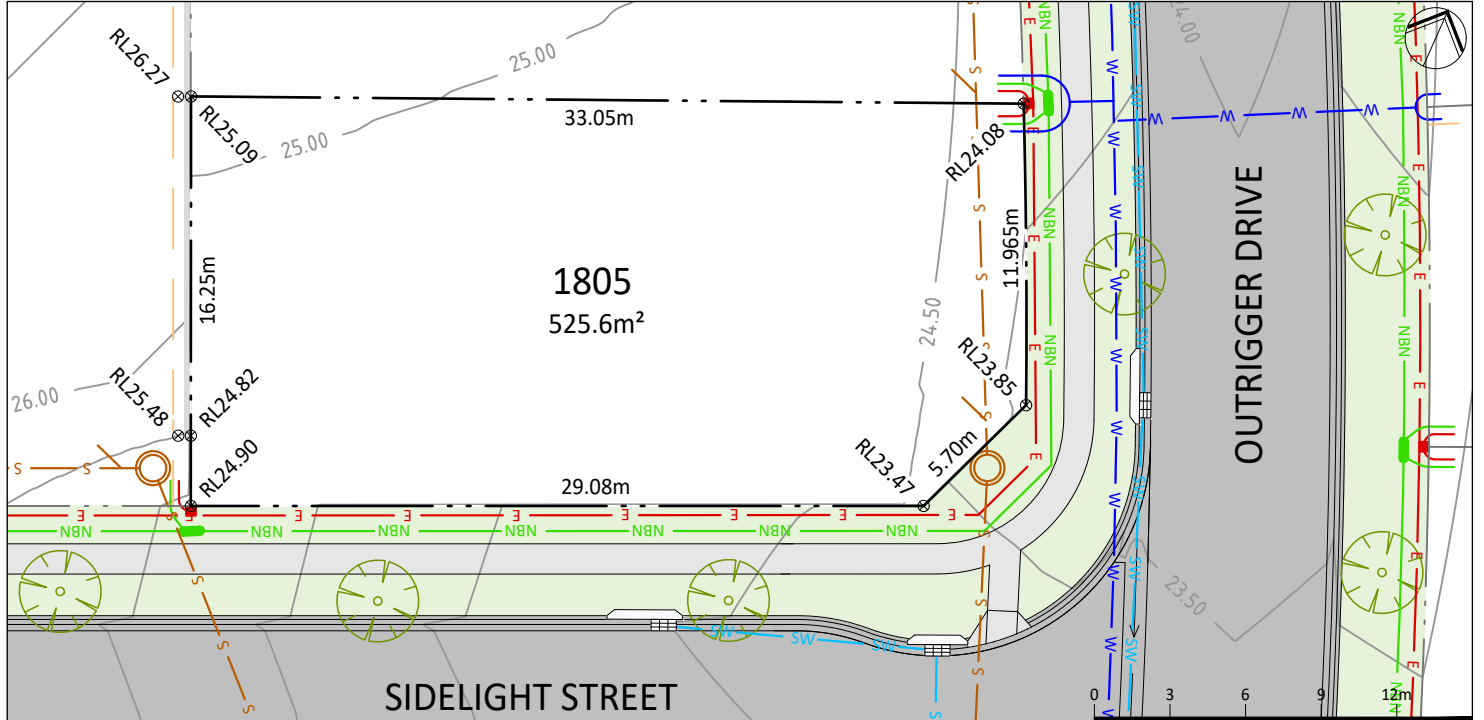

LEGEND:

	RETAINING WALL
	STORMWATER PIT
	STORMWATER PIPE
	DRAINAGE SWALE
	SEWER MAIN
	SEWER MAINTENANCE STRUCTURE
	SEWER JUNCTION
	WATERMAIN
	HYDRANT / STOP VALVE
	TELSTRA / NBN
	TELSTRA / NBN PIT
	UNDERGROUND POWER
	ELECTRICITY PILLAR
	LIGHT POLE
	EASEMENT
	STREET TREES
	CONTOURS
	BUILDING ENVELOPE

DISCLAIMER / NOTES:

- Contours are based on finished design levels and are subject to construction and Council certification and therefore should not be considered as final or as-built.
- Location of utility services including but not limited to power, water, sewer, communications and gas are subject to construction and supply authority certification and therefore should not be considered as final or as-built.
- Survey information such as boundary dimensions and areas, easements etc are subject to final survey. Purchasers should refer to the deposited plan and 88B instrument contained in the contract for sale of land for further detailed information.
- Bushfire and geotechnical classification are provided for convenience. Purchasers should refer to referenced detail specialist reports.
- This preliminary site analysis plan has been collated from various sources of design information and is provided for convenience to assist purchasers in obtaining quotation / tenders for dwelling construction.
- This document does not form part of the contract of sale of the land.
- Anticipated site classification is M - H2 or better (to be confirmed at completion of construction).
- Refer to sales plan and draft contract for information regarding easements and restrictions.
- Refer to build envelope plans for further details.

(DA) - EASEMENT TO DRAIN WATER 2 WIDE

(DB) - RESTRICTION ON THE USE OF LAND 0.7 WIDE

(DC) - EASEMENT FOR CONSTRUCTION & MAINTENANCE 0.7 WIDE

REVISION: STAGE 18 MARKETING

DATE: 9 JANUARY 2024

BY: NORTHPROP CONSULTING ENGINEERS

billyslookout.com.au



A QUALITY
MCCLOY
GROUP
PROJECT



BILLY'S LOOKOUT

EST. 2015

LAKE MACQUARIE

LOT 1806, SIDELIGHT STREET, BILLY'S LOOKOUT

MASTER PLAN



STAGE PLAN

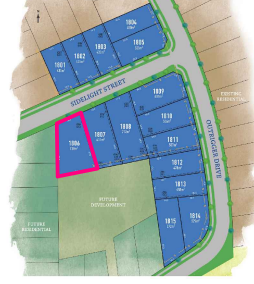

PRELIMINARY SITE ANALYSIS PLAN

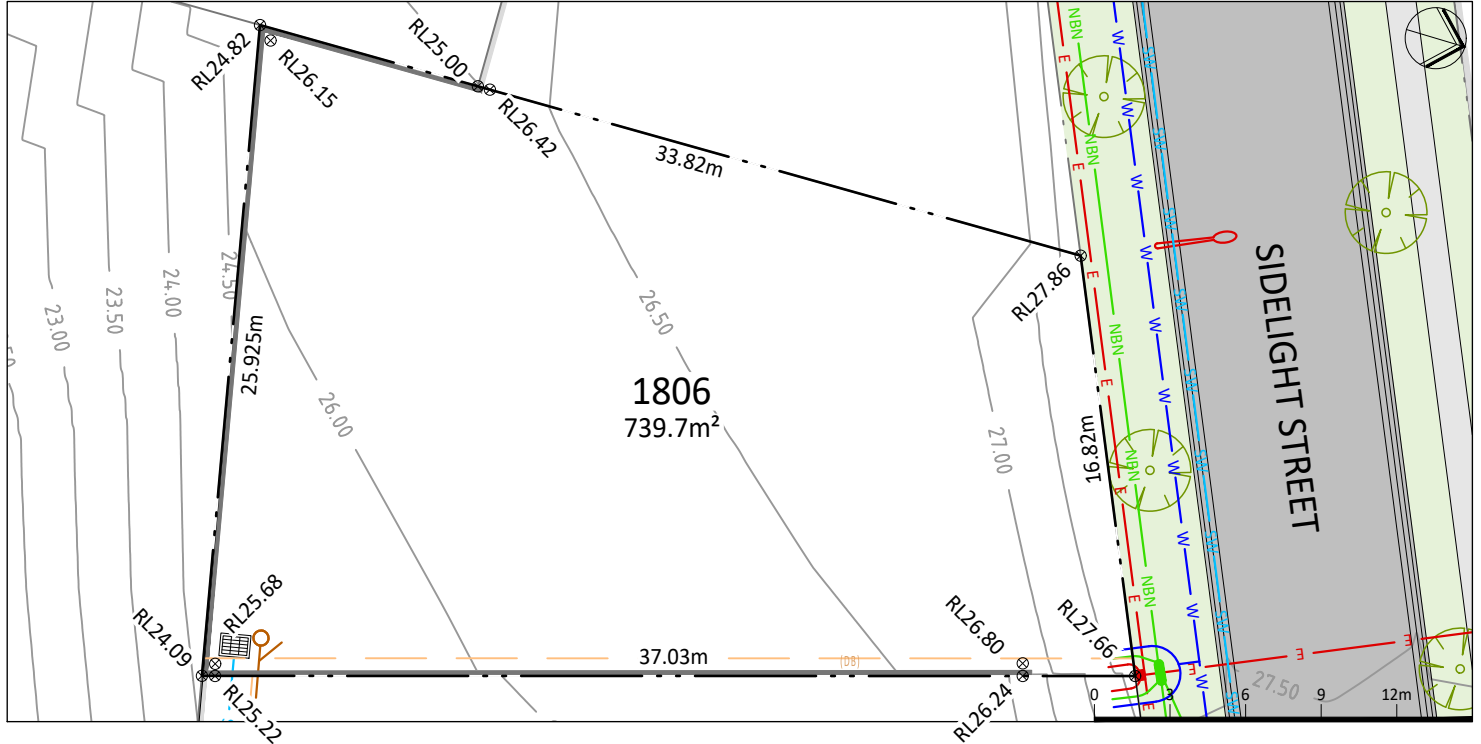

LEGEND:

	RETAINING WALL
	STORMWATER PIT
	STORMWATER PIPE
	DRAINAGE SWALE
	SEWER MAIN
	SEWER MAINTENANCE STRUCTURE
	SEWER JUNCTION
	WATERMAIN
	HYDRANT / STOP VALVE
	TELSTRA / NBN
	TELSTRA / NBN PIT
	UNDERGROUND POWER
	ELECTRICITY PILLAR
	LIGHT POLE
	EASEMENT
	STREET TREES
	CONTOURS
	BUILDING ENVELOPE

DISCLAIMER / NOTES:

- Contours are based on finished design levels and are subject to construction and Council certification and therefore should not be considered as final or as-built.
- Location of utility services including but not limited to power, water, sewer, communications and gas are subject to construction and supply authority certification and therefore should not be considered as final or as-built.
- Survey information such as boundary dimensions and areas, easements etc are subject to final survey. Purchasers should refer to the deposited plan and 88B instrument contained in the contract for sale of land for further detailed information.
- Bushfire and geotechnical classification are provided for convenience. Purchasers should refer to referenced detail specialist reports.
- This preliminary site analysis plan has been collated from various sources of design information and is provided for convenience to assist purchasers in obtaining quotation / tenders for dwelling construction.
- This document does not form part of the contract of sale of the land.
- Anticipated site classification is M - H2 or better (to be confirmed at completion of construction).
- Refer to sales plan and draft contract for information regarding easements and restrictions.
- Refer to build envelope plans for further details.

(DA) - EASEMENT TO DRAIN WATER 2 WIDE
 (DB) - RESTRICTION ON THE USE OF LAND 0.7 WIDE
 (DC) - EASEMENT FOR CONSTRUCTION & MAINTENANCE 0.7 WIDE

REVISION: STAGE 18 MARKETING
 DATE: 9 JANUARY 2024
 BY: NORTHPRO CONSULTING ENGINEERS

billyslookout.com.au



A QUALITY MCCLOY GROUP PROJECT



**BILLY'S
LOOKOUT**

EST. 2015

LAKE MACQUARIE

LOT 1807, SIDELIGHT STREET, BILLY'S LOOKOUT

MASTER PLAN



STAGE PLAN

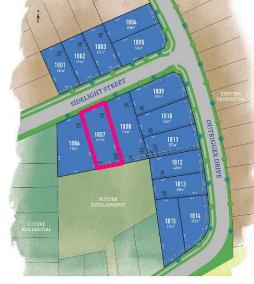

PRELIMINARY SITE ANALYSIS PLAN

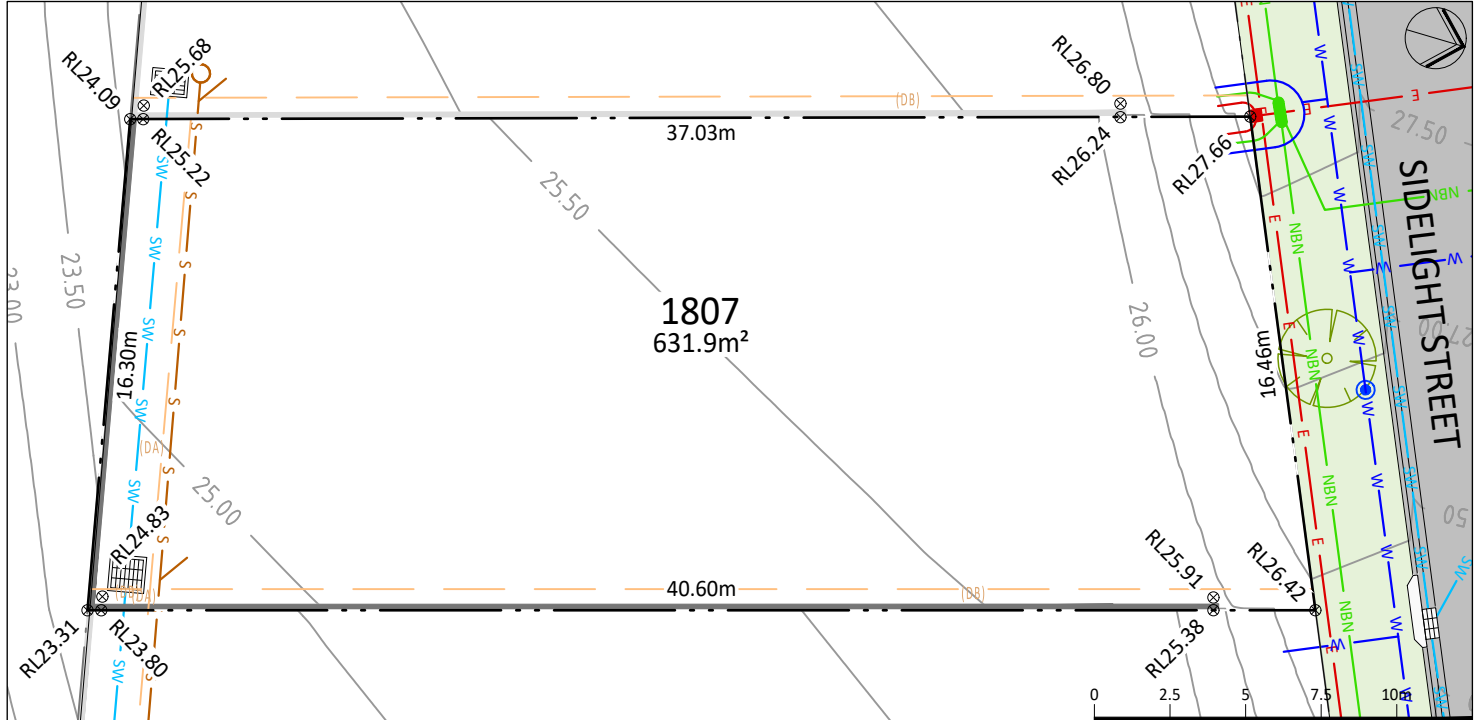

LEGEND:

	RETAINING WALL
	STORMWATER PIT
	STORMWATER PIPE
	DRAINAGE SWALE
	SEWER MAIN
	SEWER MAINTENANCE STRUCTURE
	SEWER JUNCTION
	WATERMAIN
	HYDRANT / STOP VALVE
	TELSTRA / NBN
	TELSTRA / NBN PIT
	UNDERGROUND POWER
	ELECTRICITY PILLAR
	LIGHT POLE
	EASEMENT
	STREET TREES
	CONTOURS
	BUILDING ENVELOPE

DISCLAIMER / NOTES:

1. Contours are based on finished design levels and are subject to construction and Council certification and therefore should not be considered as final or as-built.
2. Location of utility services including but not limited to power, water, sewer, communications and gas are subject to construction and supply authority certification and therefore should not be considered as final or as-built.
3. Survey information such as boundary dimensions and areas, easements etc are subject to final survey. Purchasers should refer to the deposited plan and 88B instrument contained in the contract for sale of land for further detailed information.
4. Bushfire and geotechnical classification are provided for convenience. Purchasers should refer to referenced detail specialist reports.
5. This preliminary site analysis plan has been collated from various sources of design information and is provided for convenience to assist purchasers in obtaining quotation / tenders for dwelling construction.
6. This document does not form part of the contract of sale of the land.
7. Anticipated site classification is M - H2 or better (to be confirmed at completion of construction).
8. Refer to sales plan and draft contract for information regarding easements and restrictions.
9. Refer to build envelope plans for further details.

(DA) - EASEMENT TO DRAIN WATER 2 WIDE

(DB) - RESTRICTION ON THE USE OF LAND 0.7 WIDE

(DC) - EASEMENT FOR CONSTRUCTION & MAINTENANCE 0.7 WIDE

REVISION: STAGE 18 MARKETING

DATE: 9 JANUARY 2024

BY: NORTHPROP CONSULTING ENGINEERS

billyslookout.com.au



A QUALITY
MCCLOY
GROUP
PROJECT



**BILLY'S
LOOKOUT**

EST. 2015

LAKE MACQUARIE

LOT 1808, SIDELIGHT STREET, BILLY'S LOOKOUT

MASTER PLAN



STAGE PLAN

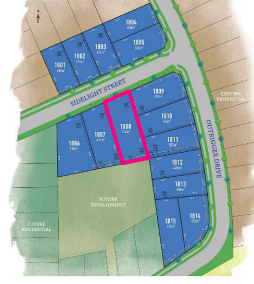

PRELIMINARY SITE ANALYSIS PLAN

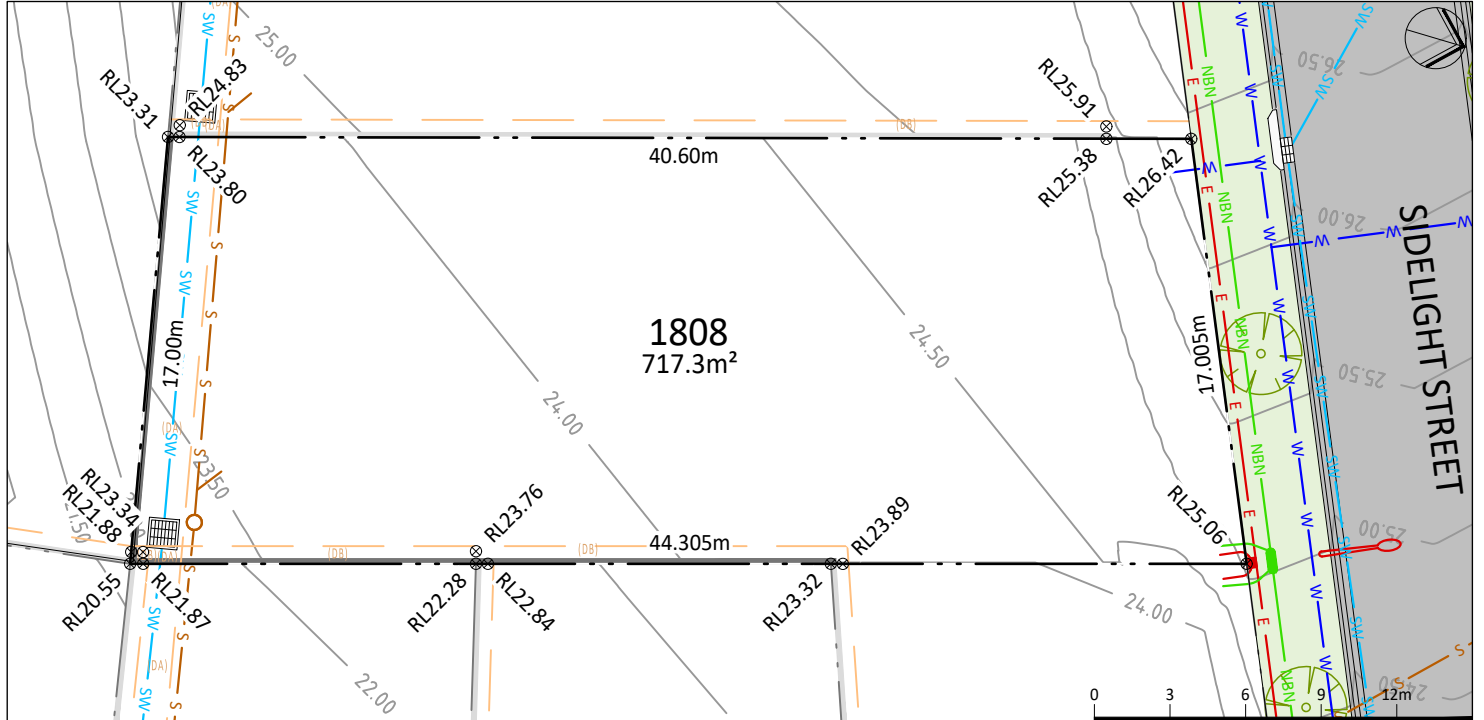

LEGEND:

	RETAINING WALL
	STORMWATER PIT
	STORMWATER PIPE
	DRAINAGE SWALE
	SEWER MAIN
	SEWER MAINTENANCE STRUCTURE
	SEWER JUNCTION
	WATERMAIN
	HYDRANT / STOP VALVE
	TELSTRA / NBN
	TELSTRA / NBN PIT
	UNDERGROUND POWER
	ELECTRICITY PILLAR
	LIGHT POLE
	EASEMENT
	STREET TREES
	CONTOURS
	BUILDING ENVELOPE

DISCLAIMER / NOTES:

1. Contours are based on finished design levels and are subject to construction and Council certification and therefore should not be considered as final or as-built.
2. Location of utility services including but not limited to power, water, sewer, communications and gas are subject to construction and supply authority certification and therefore should not be considered as final or as-built.
3. Survey information such as boundary dimensions and areas, easements etc are subject to final survey. Purchasers should refer to the deposited plan and 88B instrument contained in the contract for sale of land for further detailed information.
4. Bushfire and geotechnical classification are provided for convenience. Purchasers should refer to referenced detail specialist reports.
5. This preliminary site analysis plan has been collated from various sources of design information and is provided for convenience to assist purchasers in obtaining quotation / tenders for dwelling construction.
6. This document does not form part of the contract of sale of the land.
7. Anticipated site classification is M - H2 or better (to be confirmed at completion of construction).
8. Refer to sales plan and draft contract for information regarding easements and restrictions.
9. Refer to build envelope plans for further details.

(DA) - EASEMENT TO DRAIN WATER 2 WIDE

(DB) - RESTRICTION ON THE USE OF LAND 0.7 WIDE

(DC) - EASEMENT FOR CONSTRUCTION & MAINTENANCE 0.7 WIDE

REVISION: STAGE 18 MARKETING

DATE: 9 JANUARY 2024

BY: NORTHPRO CONSULTING ENGINEERS

billyslookout.com.au



A QUALITY
MCCLOY
GROUP
PROJECT



BILLY'S LOOKOUT

EST. 2015

LAKE MACQUARIE

LOT 1809, OUTRIGGER DRIVE, BILLY'S LOOKOUT

MASTER PLAN



STAGE PLAN

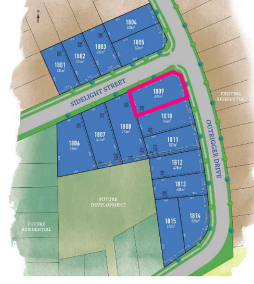

PRELIMINARY SITE ANALYSIS PLAN

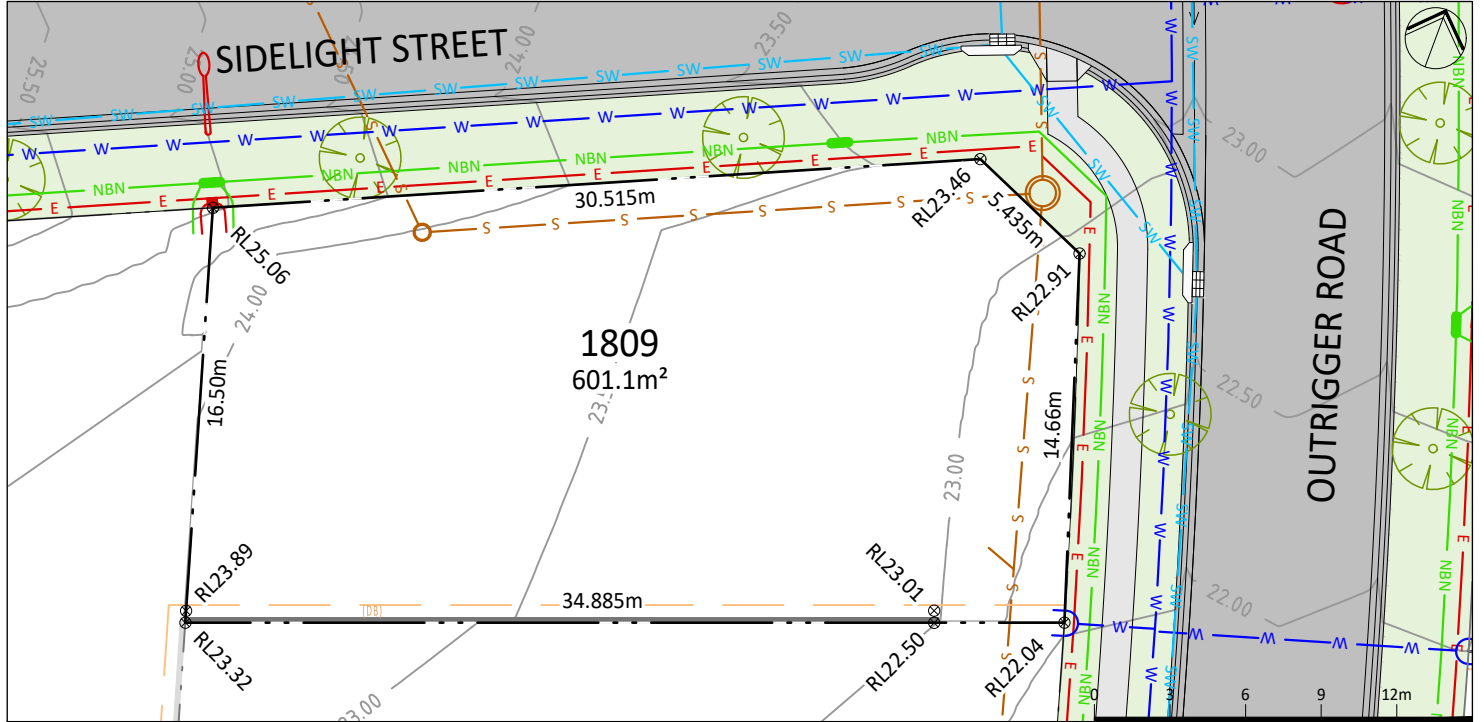

LEGEND:

	RETAINING WALL
	STORMWATER PIT
	STORMWATER PIPE
	DRAINAGE SWALE
	SEWER MAIN
	SEWER MAINTENANCE STRUCTURE
	SEWER JUNCTION
	WATERMAIN
	HYDRANT / STOP VALVE
	TELSTRA / NBN
	TELSTRA / NBN PIT
	UNDERGROUND POWER
	ELECTRICITY PILLAR
	LIGHT POLE
	EASEMENT
	STREET TREES
	CONTOURS
	BUILDING ENVELOPE

DISCLAIMER / NOTES:

- Contours are based on finished design levels and are subject to construction and Council certification and therefore should not be considered as final or as-built.
- Location of utility services including but not limited to power, water, sewer, communications and gas are subject to construction and supply authority certification and therefore should not be considered as final or as-built.
- Survey information such as boundary dimensions and areas, easements etc are subject to final survey. Purchasers should refer to the deposited plan and 88B instrument contained in the contract for sale of land for further detailed information.
- Bushfire and geotechnical classification are provided for convenience. Purchasers should refer to referenced detail specialist reports.
- This preliminary site analysis plan has been collated from various sources of design information and is provided for convenience to assist purchasers in obtaining quotation / tenders for dwelling construction.
- This document does not form part of the contract of sale of the land.
- Anticipated site classification is M - H2 or better (to be confirmed at completion of construction).
- Refer to sales plan and draft contract for information regarding easements and restrictions.
- Refer to build envelope plans for further details.

(DA) - EASEMENT TO DRAIN WATER 2 WIDE

(DB) - RESTRICTION ON THE USE OF LAND 0.7 WIDE

(DC) - EASEMENT FOR CONSTRUCTION & MAINTENANCE 0.7 WIDE

REVISION: STAGE 18 MARKETING

DATE: 9 JANUARY 2024

BY: NORTHPRO CONSULTING ENGINEERS

billyslookout.com.au



A QUALITY
MCCLOY
GROUP
PROJECT



**BILLY'S
LOOKOUT**

EST. 2015

LAKE MACQUARIE

LOT 1810, OUTRIGGER DRIVE, BILLY'S LOOKOUT

MASTER PLAN



STAGE PLAN

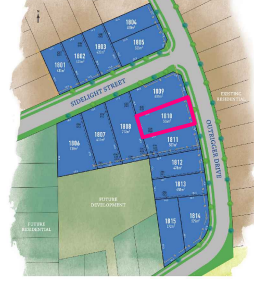

PRELIMINARY SITE ANALYSIS PLAN

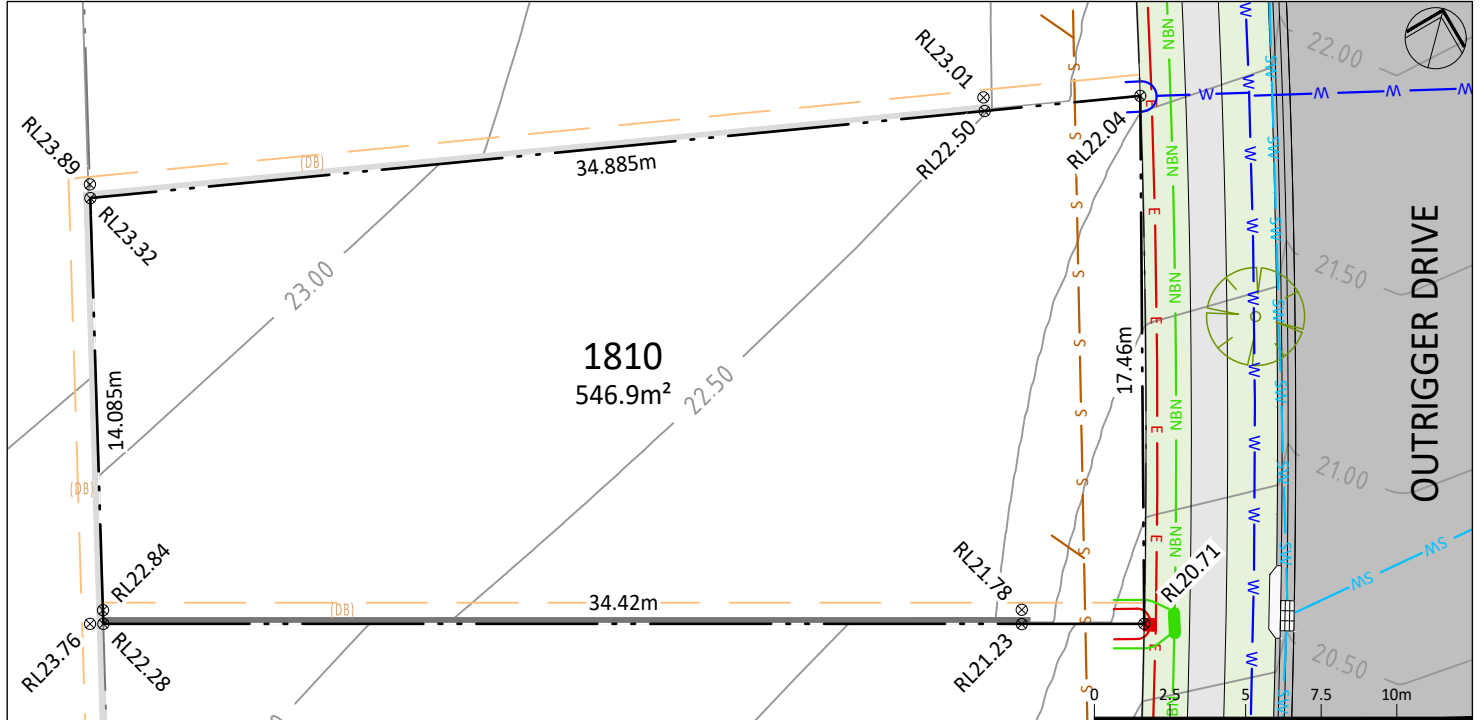

LEGEND:

	RETAINING WALL
	STORMWATER PIT
	STORMWATER PIPE
	DRAINAGE SWALE
	SEWER MAIN
	SEWER MAINTENANCE STRUCTURE
	SEWER JUNCTION
	WATERMAIN
	HYDRANT / STOP VALVE
	TELSTRA / NBN
	TELSTRA / NBN PIT
	UNDERGROUND POWER
	ELECTRICITY PILLAR
	LIGHT POLE
	EASEMENT
	STREET TREES
	CONTOURS
	BUILDING ENVELOPE

DISCLAIMER / NOTES:

1. Contours are based on finished design levels and are subject to construction and Council certification and therefore should not be considered as final or as-built.
2. Location of utility services including but not limited to power, water, sewer, communications and gas are subject to construction and supply authority certification and therefore should not be considered as final or as-built.
3. Survey information such as boundary dimensions and areas, easements etc are subject to final survey. Purchasers should refer to the deposited plan and 88B instrument contained in the contract for sale of land for further detailed information.
4. Bushfire and geotechnical classification are provided for convenience. Purchasers should refer to referenced detail specialist reports.
5. This preliminary site analysis plan has been collated from various sources of design information and is provided for convenience to assist purchasers in obtaining quotation / tenders for dwelling construction.
6. This document does not form part of the contract of sale of the land.
7. Anticipated site classification is M - H2 or better (to be confirmed at completion of construction).
8. Refer to sales plan and draft contract for information regarding easements and restrictions.
9. Refer to build envelope plans for further details.

(DA) - EASEMENT TO DRAIN WATER 2 WIDE

(DB) - RESTRICTION ON THE USE OF LAND 0.7 WIDE

(DC) - EASEMENT FOR CONSTRUCTION & MAINTENANCE 0.7 WIDE

REVISION: STAGE 18 MARKETING

DATE: 9 JANUARY 2024

BY: NORTHPROP CONSULTING ENGINEERS

billyslookout.com.au



A QUALITY
MCCLOY
GROUP
PROJECT



BILLY'S LOOKOUT

EST. 2015

LAKE MACQUARIE

LOT 1811, OUTRIGGER DRIVE, BILLY'S LOOKOUT

MASTER PLAN



STAGE PLAN



PRELIMINARY SITE ANALYSIS PLAN

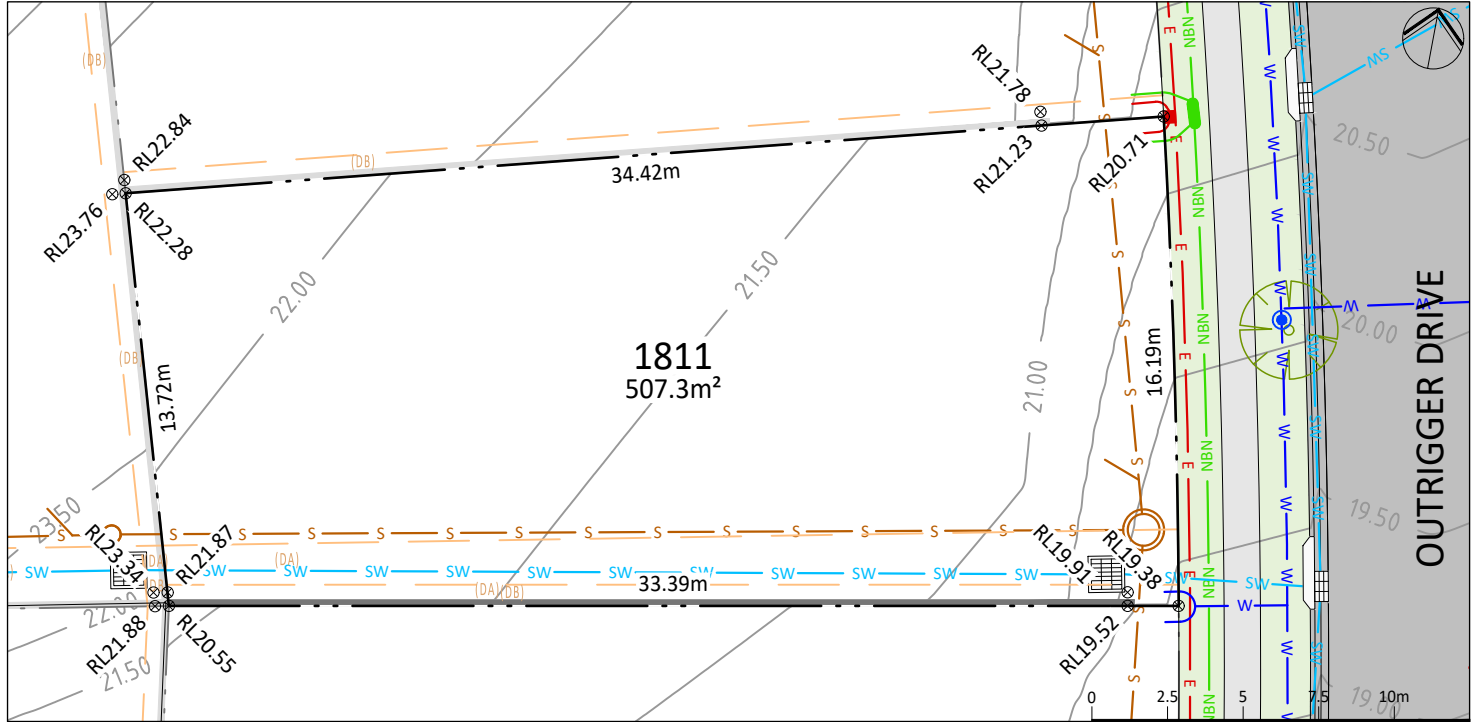

LEGEND:

	RETAINING WALL
	STORMWATER PIT
	STORMWATER PIPE
	DRAINAGE SWALE
	SEWER MAIN
	SEWER MAINTENANCE STRUCTURE
	SEWER JUNCTION
	WATERMAIN
	HYDRANT / STOP VALVE
	TELSTRA / NBN
	TELSTRA / NBN PIT
	UNDERGROUND POWER
	ELECTRICITY PILLAR
	LIGHT POLE
	EASEMENT
	STREET TREES
	CONTOURS
	BUILDING ENVELOPE

DISCLAIMER / NOTES:

1. Contours are based on finished design levels and are subject to construction and Council certification and therefore should not be considered as final or as-built.
2. Location of utility services including but not limited to power, water, sewer, communications and gas are subject to construction and supply authority certification and therefore should not be considered as final or as-built.
3. Survey information such as boundary dimensions and areas, easements etc are subject to final survey. Purchasers should refer to the deposited plan and 88B instrument contained in the contract for sale of land for further detailed information.
4. Bushfire and geotechnical classification are provided for convenience. Purchasers should refer to referenced detail specialist reports.
5. This preliminary site analysis plan has been collated from various sources of design information and is provided for convenience to assist purchasers in obtaining quotation / tenders for dwelling construction.
6. This document does not form part of the contract of sale of the land.
7. Anticipated site classification is M - H2 or better (to be confirmed at completion of construction).
8. Refer to sales plan and draft contract for information regarding easements and restrictions.
9. Refer to build envelope plans for further details.

(DA) - EASEMENT TO DRAIN WATER 2 WIDE

(DB) - RESTRICTION ON THE USE OF LAND 0.7 WIDE

(DC) - EASEMENT FOR CONSTRUCTION & MAINTENANCE 0.7 WIDE

REVISION: STAGE 18 MARKETING

DATE: 9 JANUARY 2024

BY: NORTHPROP CONSULTING ENGINEERS

billyslookout.com.au



A QUALITY
MCCLOY
GROUP
PROJECT



BILLY'S LOOKOUT

EST. 2015

LAKE MACQUARIE

LOT 1812, OUTRIGGER DRIVE, BILLY'S LOOKOUT

MASTER PLAN



STAGE PLAN

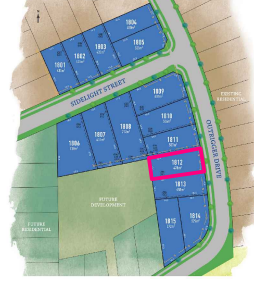

PRELIMINARY SITE ANALYSIS PLAN

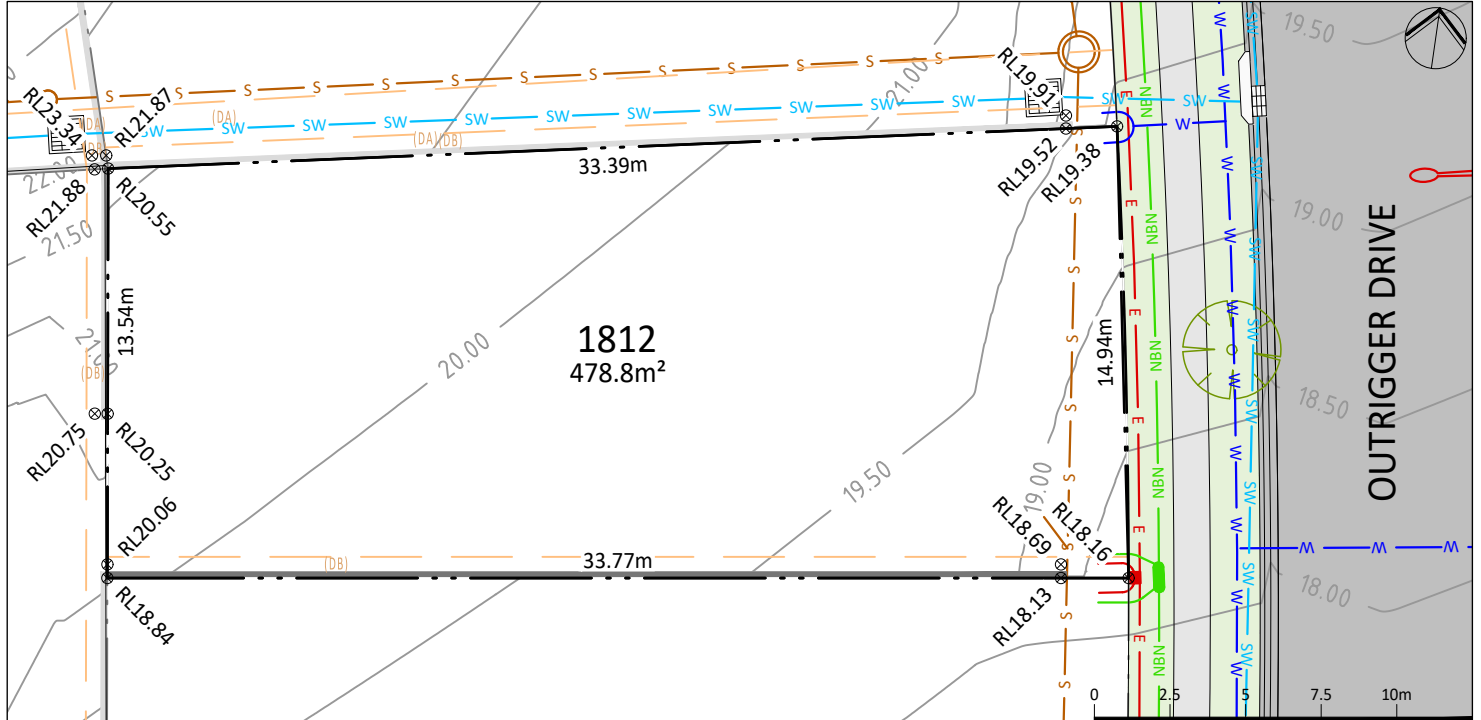

LEGEND:

	RETAINING WALL
	STORMWATER PIT
	STORMWATER PIPE
	DRAINAGE SWALE
	SEWER MAIN
	SEWER MAINTENANCE STRUCTURE
	SEWER JUNCTION
	WATERMAIN
	HYDRANT / STOP VALVE
	TELSTRA / NBN
	TELSTRA / NBN PIT
	UNDERGROUND POWER
	ELECTRICITY PILLAR
	LIGHT POLE
	EASEMENT
	STREET TREES
	CONTOURS
	BUILDING ENVELOPE

DISCLAIMER / NOTES:

- Contours are based on finished design levels and are subject to construction and Council certification and therefore should not be considered as final or as-built.
- Location of utility services including but not limited to power, water, sewer, communications and gas are subject to construction and supply authority certification and therefore should not be considered as final or as-built.
- Survey information such as boundary dimensions and areas, easements etc are subject to final survey. Purchasers should refer to the deposited plan and 88B instrument contained in the contract for sale of land for further detailed information.
- Bushfire and geotechnical classification are provided for convenience. Purchasers should refer to referenced detail specialist reports.
- This preliminary site analysis plan has been collated from various sources of design information and is provided for convenience to assist purchasers in obtaining quotation / tenders for dwelling construction.
- This document does not form part of the contract of sale of the land.
- Anticipated site classification is M - H2 or better (to be confirmed at completion of construction).
- Refer to sales plan and draft contract for information regarding easements and restrictions.
- Refer to build envelope plans for further details.

(DA) - EASEMENT TO DRAIN WATER 2 WIDE

(DB) - RESTRICTION ON THE USE OF LAND 0.7 WIDE

(DC) - EASEMENT FOR CONSTRUCTION & MAINTENANCE 0.7 WIDE

REVISION: STAGE 18 MARKETING

DATE: 9 JANUARY 2024

BY: NORTHROP CONSULTING ENGINEERS

billyslookout.com.au



A QUALITY
MCCLOY
GROUP
PROJECT



**BILLY'S
LOOKOUT**

EST. 2015

LAKE MACQUARIE

LOT 1813, OUTRIGGER DRIVE, BILLY'S LOOKOUT

MASTER PLAN



STAGE PLAN

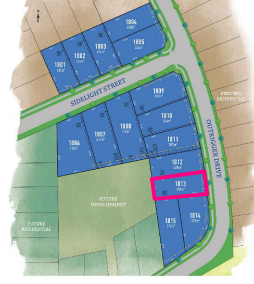

PRELIMINARY SITE ANALYSIS PLAN

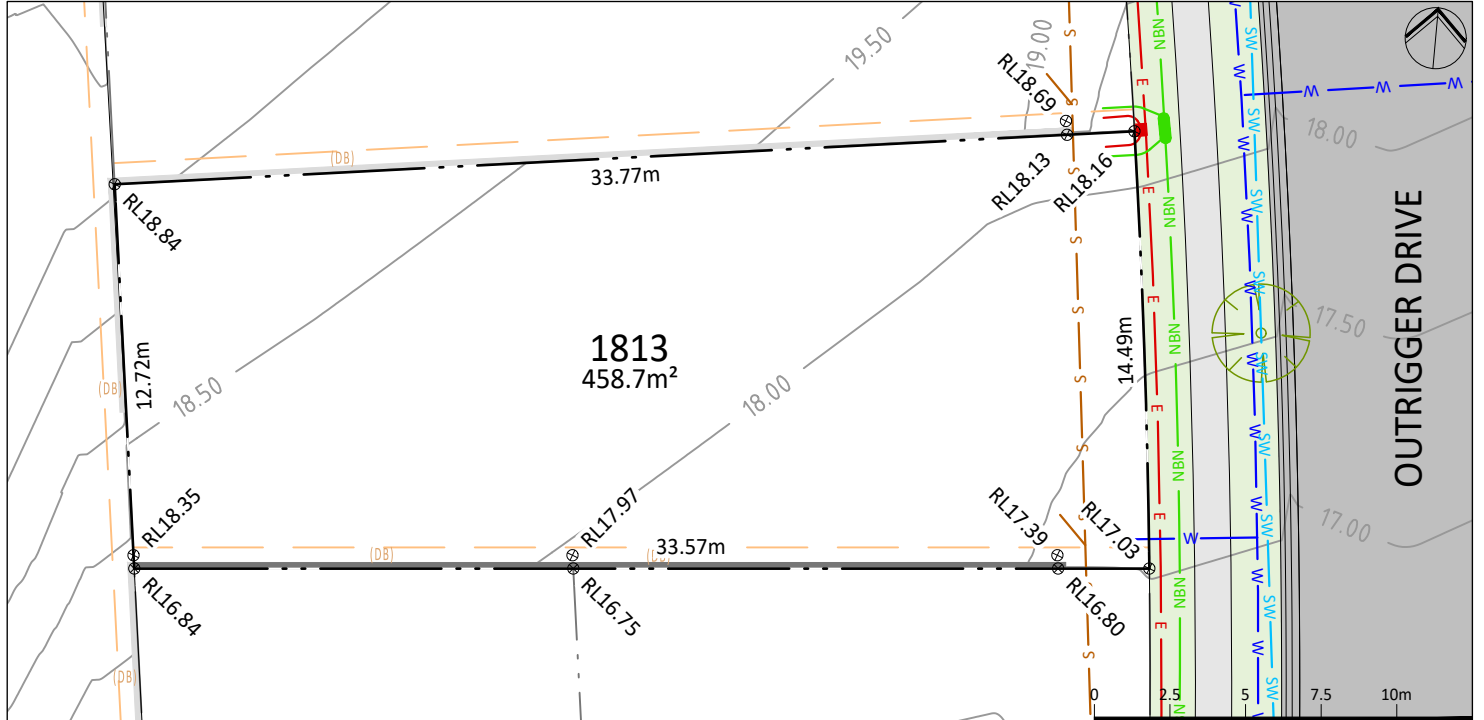

LEGEND:

	RETAINING WALL
	STORMWATER PIT
	STORMWATER PIPE
	DRAINAGE SWALE
	SEWER MAIN
	SEWER MAINTENANCE STRUCTURE
	SEWER JUNCTION
	WATERMAIN
	HYDRANT / STOP VALVE
	TELSTRA / NBN
	TELSTRA / NBN PIT
	UNDERGROUND POWER
	ELECTRICITY PILLAR
	LIGHT POLE
	EASEMENT
	STREET TREES
	CONTOURS
	BUILDING ENVELOPE

DISCLAIMER / NOTES:

- Contours are based on finished design levels and are subject to construction and Council certification and therefore should not be considered as final or as-built.
- Location of utility services including but not limited to power, water, sewer, communications and gas are subject to construction and supply authority certification and therefore should not be considered as final or as-built.
- Survey information such as boundary dimensions and areas, easements etc are subject to final survey. Purchasers should refer to the deposited plan and 88B instrument contained in the contract for sale of land for further detailed information.
- Bushfire and geotechnical classification are provided for convenience. Purchasers should refer to referenced detail specialist reports.
- This preliminary site analysis plan has been collated from various sources of design information and is provided for convenience to assist purchasers in obtaining quotation / tenders for dwelling construction.
- This document does not form part of the contract of sale of the land.
- Anticipated site classification is M - H2 or better (to be confirmed at completion of construction).
- Refer to sales plan and draft contract for information regarding easements and restrictions.
- Refer to build envelope plans for further details.

(DA) - EASEMENT TO DRAIN WATER 2 WIDE

(DB) - RESTRICTION ON THE USE OF LAND 0.7 WIDE

(DC) - EASEMENT FOR CONSTRUCTION & MAINTENANCE 0.7 WIDE

REVISION: STAGE 18 MARKETING

DATE: 9 JANUARY 2024

BY: NORTHPRO CONSULTING ENGINEERS

billyslookout.com.au



A QUALITY
MCCLOY
GROUP
PROJECT



**BILLY'S
LOOKOUT**

EST. 2015

LAKE MACQUARIE

LOT 1814, OUTRIGGER DRIVE, BILLY'S LOOKOUT

MASTER PLAN



STAGE PLAN

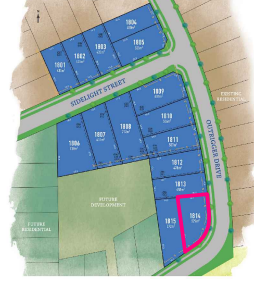

PRELIMINARY SITE ANALYSIS PLAN

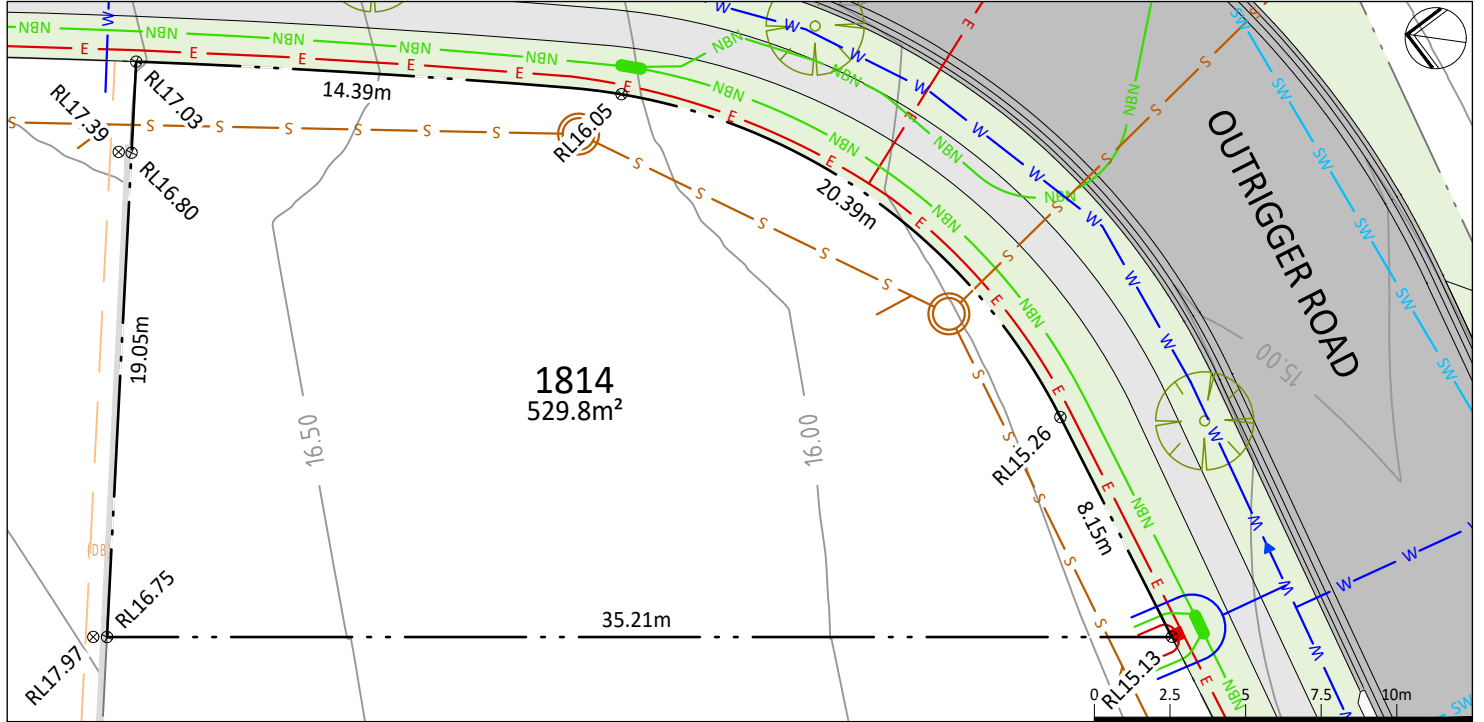

LEGEND:

	RETAINING WALL
	STORMWATER PIT
	STORMWATER PIPE
	DRAINAGE SWALE
	SEWER MAIN
	SEWER MAINTENANCE STRUCTURE
	SEWER JUNCTION
	WATERMAIN
	HYDRANT / STOP VALVE
	TELSTRA / NBN
	TELSTRA / NBN PIT
	UNDERGROUND POWER
	ELECTRICITY PILLAR
	LIGHT POLE
	EASEMENT
	STREET TREES
	CONTOURS
	BUILDING ENVELOPE

DISCLAIMER / NOTES:

1. Contours are based on finished design levels and are subject to construction and Council certification and therefore should not be considered as final or as-built.
2. Location of utility services including but not limited to power, water, sewer, communications and gas are subject to construction and supply authority certification and therefore should not be considered as final or as-built.
3. Survey information such as boundary dimensions and areas, easements etc are subject to final survey. Purchasers should refer to the deposited plan and 88B instrument contained in the contract for sale of land for further detailed information.
4. Bushfire and geotechnical classification are provided for convenience. Purchasers should refer to referenced detail specialist reports.
5. This preliminary site analysis plan has been collated from various sources of design information and is provided for convenience to assist purchasers in obtaining quotation / tenders for dwelling construction.
6. This document does not form part of the contract of sale of the land.
7. Anticipated site classification is M - H2 or better (to be confirmed at completion of construction).
8. Refer to sales plan and draft contract for information regarding easements and restrictions.
9. Refer to build envelope plans for further details.

(DA) - EASEMENT TO DRAIN WATER 2 WIDE

(DB) - RESTRICTION ON THE USE OF LAND 0.7 WIDE

(DC) - EASEMENT FOR CONSTRUCTION & MAINTENANCE 0.7 WIDE

REVISION: STAGE 18 MARKETING

DATE: 9 JANUARY 2024

BY: NORTHPRO CONSULTING ENGINEERS

billyslookout.com.au



A QUALITY
MCCLOY
GROUP
PROJECT



BILLY'S LOOKOUT

EST. 2015

LAKE MACQUARIE

LOT 1815, OUTRIGGER DRIVE, BILLY'S LOOKOUT

MASTER PLAN



STAGE PLAN

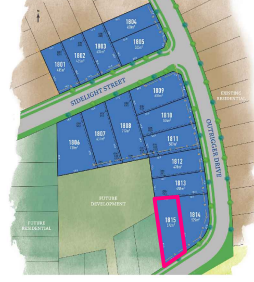

PRELIMINARY SITE ANALYSIS PLAN

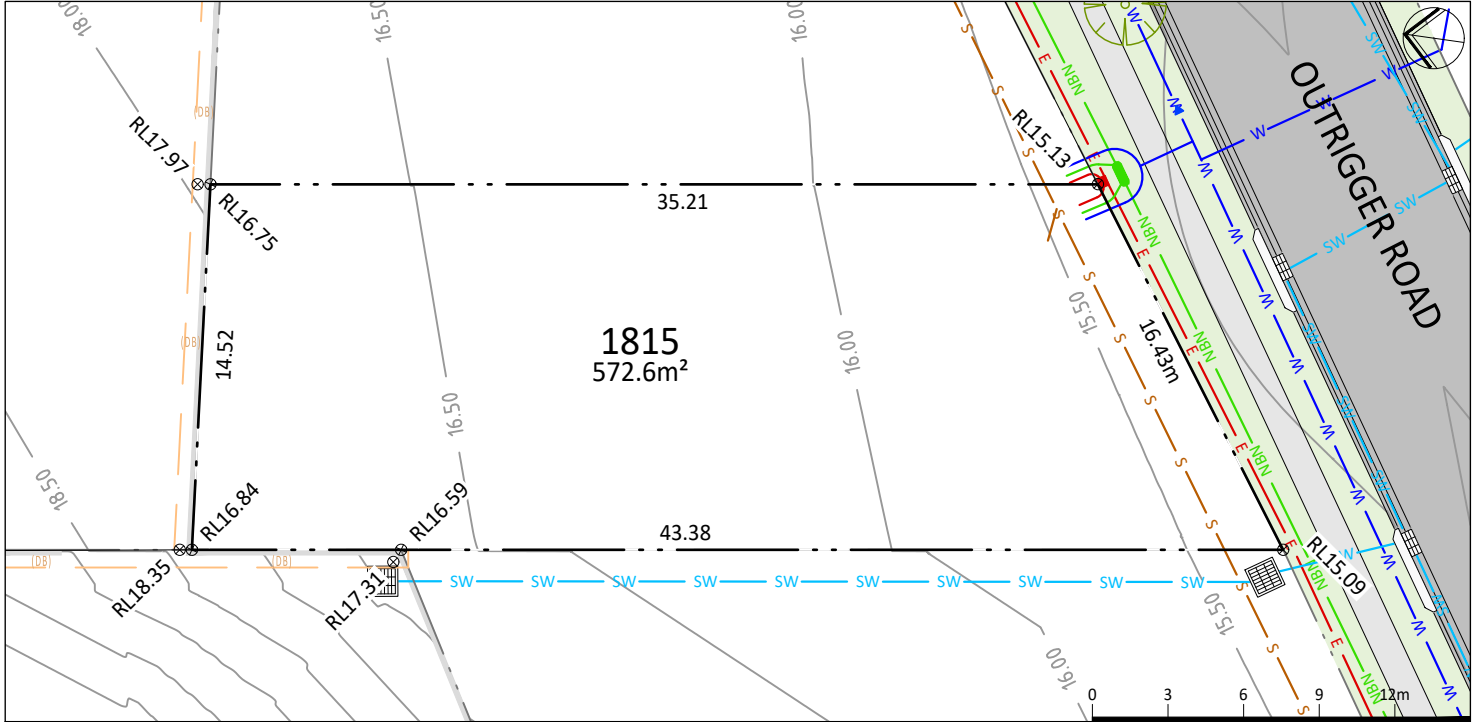

LEGEND:

	RETAINING WALL
	STORMWATER PIT
	STORMWATER PIPE
	DRAINAGE SWALE
	SEWER MAIN
	SEWER MAINTENANCE STRUCTURE
	SEWER JUNCTION
	WATERMAIN
	HYDRANT / STOP VALVE
	TELSTRA / NBN
	TELSTRA / NBN PIT
	UNDERGROUND POWER
	ELECTRICITY PILLAR
	LIGHT POLE
	EASEMENT
	STREET TREES
	CONTOURS
	BUILDING ENVELOPE

DISCLAIMER / NOTES:

- Contours are based on finished design levels and are subject to construction and Council certification and therefore should not be considered as final or as-built.
- Location of utility services including but not limited to power, water, sewer, communications and gas are subject to construction and supply authority certification and therefore should not be considered as final or as-built.
- Survey information such as boundary dimensions and areas, easements etc are subject to final survey. Purchasers should refer to the deposited plan and 88B instrument contained in the contract for sale of land for further detailed information.
- Bushfire and geotechnical classification are provided for convenience. Purchasers should refer to referenced detail specialist reports.
- This preliminary site analysis plan has been collated from various sources of design information and is provided for convenience to assist purchasers in obtaining quotation / tenders for dwelling construction.
- This document does not form part of the contract of sale of the land.
- Anticipated site classification is M - H2 or better (to be confirmed at completion of construction).
- Refer to sales plan and draft contract for information regarding easements and restrictions.
- Refer to build envelope plans for further details.

(DA) - EASEMENT TO DRAIN WATER 2 WIDE

(DB) - RESTRICTION ON THE USE OF LAND 0.7 WIDE

(DC) - EASEMENT FOR CONSTRUCTION & MAINTENANCE 0.7 WIDE

REVISION: STAGE 18 MARKETING

DATE: 9 JANUARY 2024

BY: NORTHPRO CONSULTING ENGINEERS

billyslookout.com.au



A QUALITY
MCCLOY
GROUP
PROJECT